

HYDRO-BOOST WITH RAM ASSIST (TC PUMP)

Hose installation diagram

POWER STEERING FLUID: Howe Power Steering Fluid PN 1105
 (GM Mr. Goodwrench® PN: 89020661 may be substituted if needed)

CAUTION:

DO NOT USE ATF (AUTOMATIC TRANSMISSION FLUID)

NOTE: Hose lengths will vary with each installation, custom hoses must be fabricated.
 Hose Kit P/N 950 available separately.

BOTH RETURN LINES (AN-8 AND AN-10)
 MUST BE LOW PRESSURE OIL SOLUBLE
 BRAIDED CLOTH (SUCH AS PUSHLOC®)

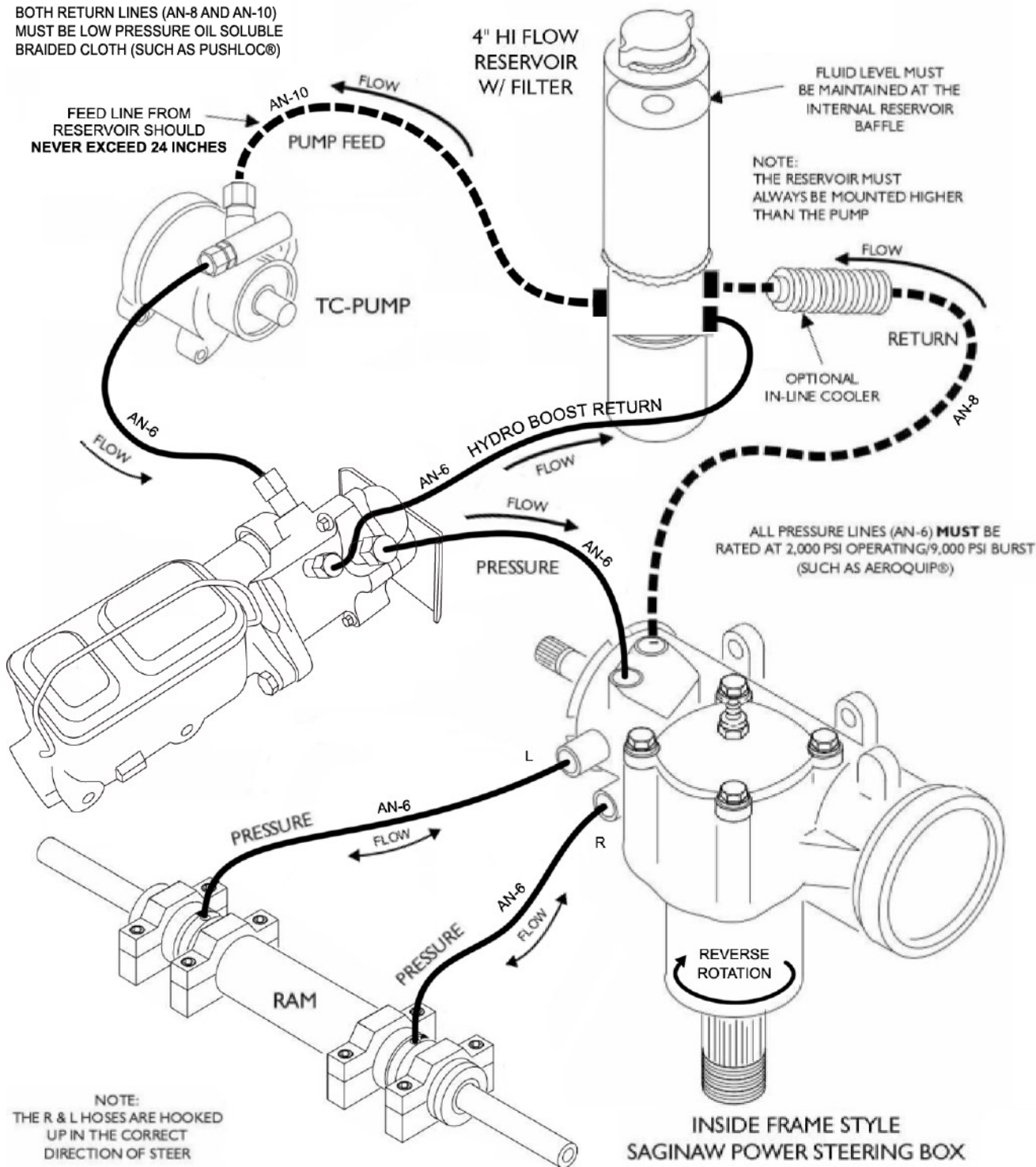

IF YOU HAVE ANY QUESTIONS ABOUT THE INSTALL CALL HOWE PERFORMANCE (619) 561-7764