

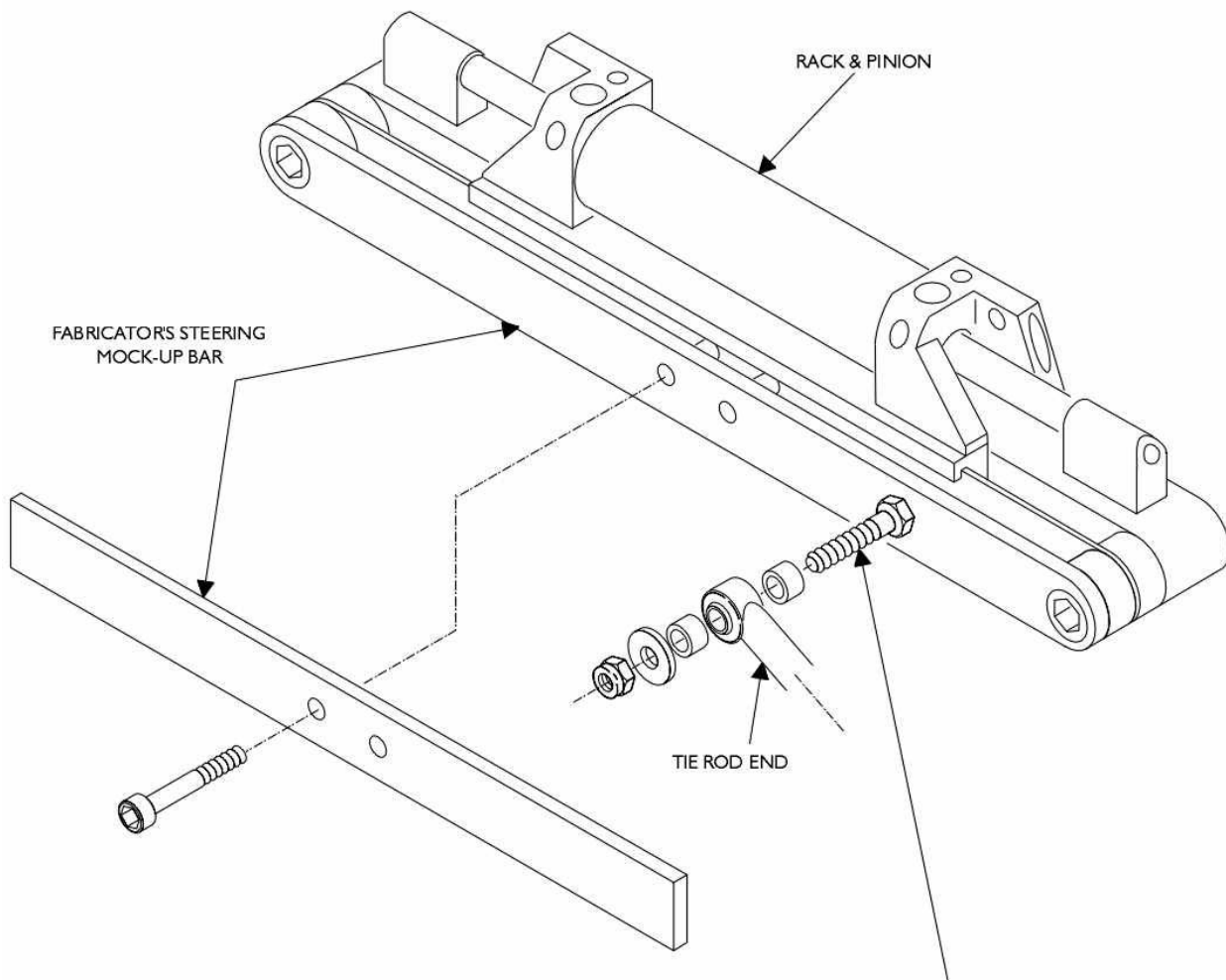

# TRUGGY RACK

**WARNING:**  
THE FABRICATION MOCK-UP BARS ARE NOT TO BE USED FOR FINAL SUSPENSION WORK. THESE BARS ARE PROVIDED BY HOWE PERFORMANCE ONLY AS A TOOL TO THE FABRICATOR TO ESTABLISH THE CORRECT STEERING SETUP.

**CAUTION:**  
WHEN WELDING TO THE MOCK-UP BARS, ATTACH THE WELDER'S GROUND TO THE MOCK-UP BARS ONLY. SERIOUS DAMAGE WILL OCCUR TO THE RACK & PINION CYLINDER IF GROUNDING IS THROUGH THE CHASSIS.



TACK WELD A CORRECTLY SIZED BOLT TO THE INNER MOCK-UP BAR AT THE APPROX. POINT OF THE CORRECT STEERING GEOMETRY FOR THE CHASSIS. CYCLE THE STEERING AND SUSPENSION AND CHECK FOR BUMP STEER, ETC. MOVE AND RE-TACK WELD THE BOLT AS NECESSARY TO FINE TUNE THE SETUP.

**CAUTION:**  
WHEN WELDING TO THE MOCK-UP BARS, ATTACH THE WELDER'S GROUND TO THE MOCK-UP BARS ONLY. SERIOUS DAMAGE WILL OCCUR TO THE RACK & PINION CYLINDER IF GROUNDING IS THROUGH THE CHASSIS.

IF YOU HAVE ANY QUESTIONS ABOUT THE INSTALL CALL HOWE PERFORMANCE (619) 561-7764

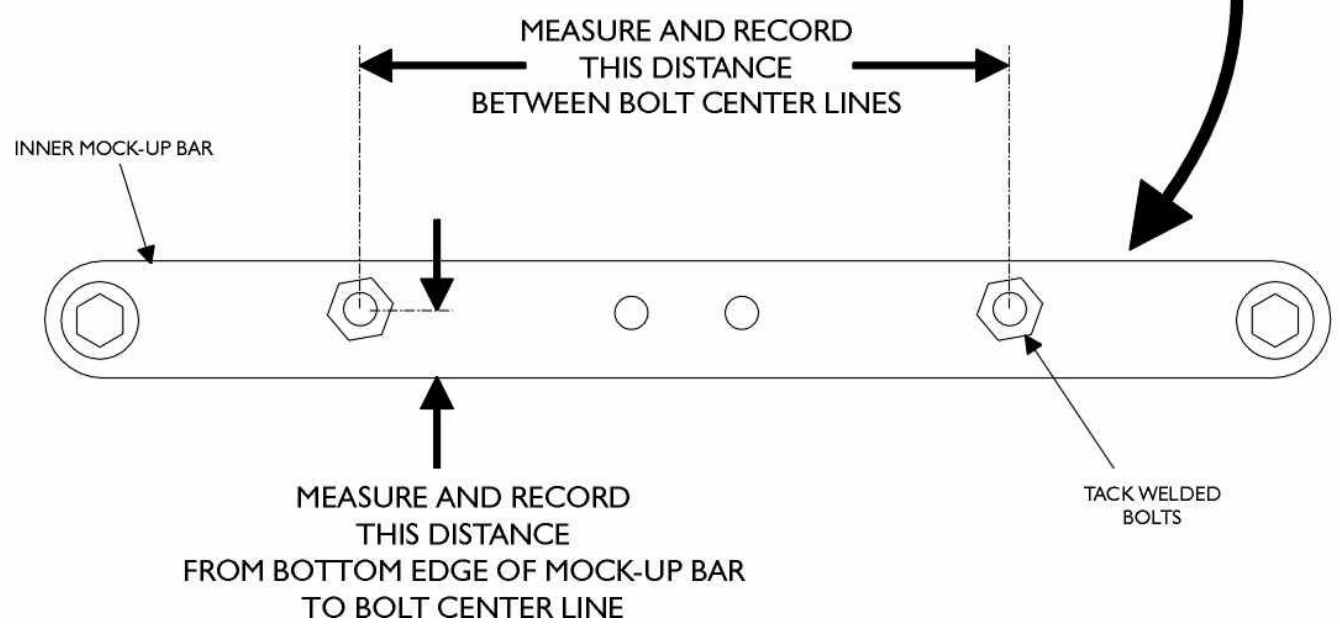
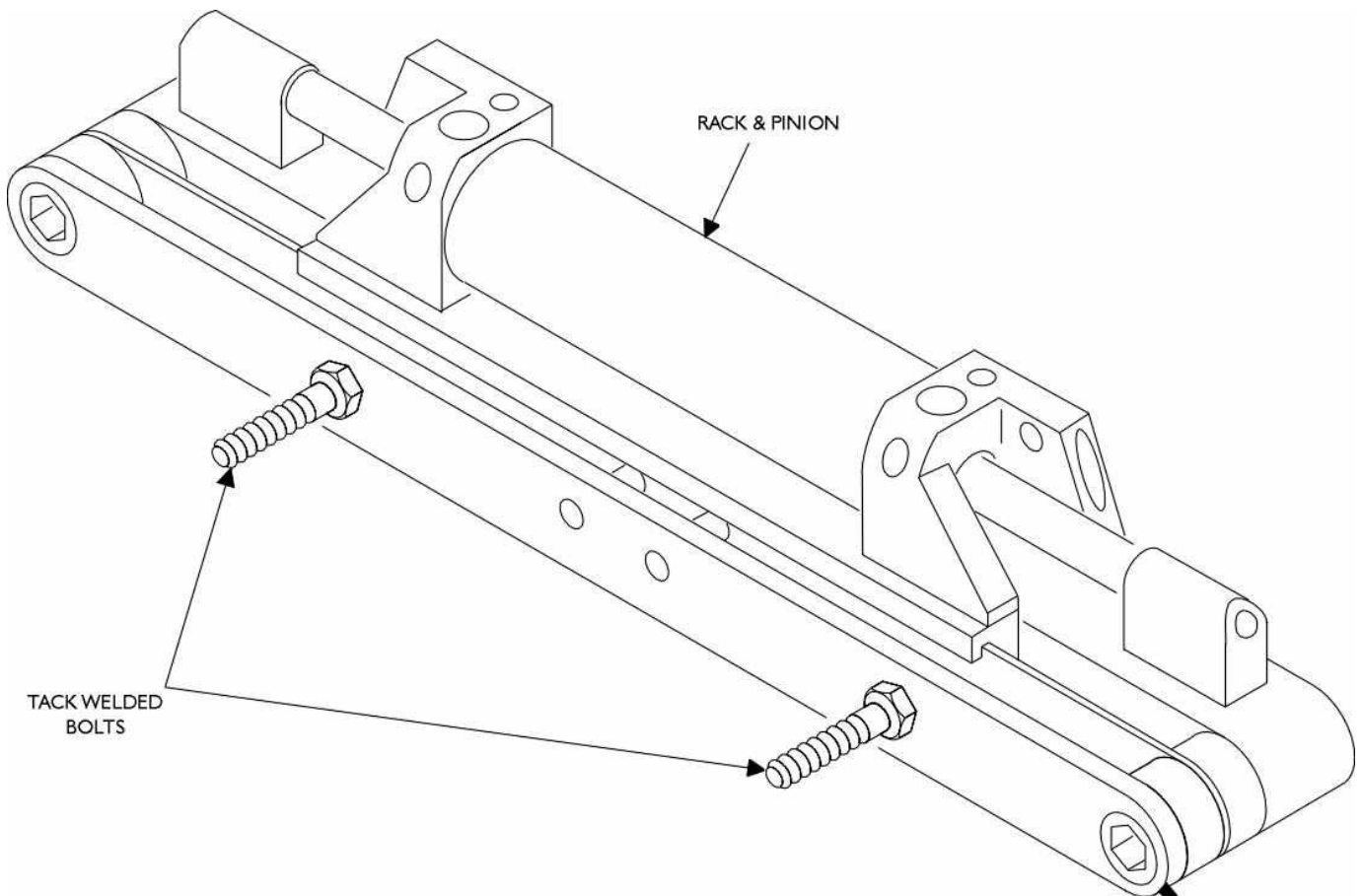

IF YOU HAVE ANY QUESTIONS ABOUT THE INSTALL CALL HOWE PERFORMANCE (619) 561-7764